



MRO
GUANGZHOU

2025

**MRO
GUANGZHOU
Exhibitor Manual**

**Guangzhou Aerotropolis Expo Center
March 18—20, 2025**

CONTENTS

01 BASIC INFORMATION	Basic Information	7
	Organization	8
	Venue	9
	Transportation	10
02 BOOTH DESIGN AND CONSTRUCTION	Official Contractor	13
	Facility Leasing Services	14
	Standard Booth	15
	Customized Special Booth	16
03 EXHIBITION SERVICES	General Information	19
	Exhibition Service Provider	21
	Exhibits Transportation	23
04 ATTACHED	Attached-Plants Rental	27
	Attached- Furniture Rental	30
	Fascia Board	33

TIPS

Dear Exhibitors:

In order to help you understand the exhibition hall facilities and various requirements of the exhibition, and smoothly complete the pre - exhibition preparation work, we provide this "Exhibitor Manual" to enable you to handle the necessary exhibition procedures more conveniently and efficiently.

1.Filling out Forms

All types of forms required to be filled out are listed in the "Attached" of this "Exhibitor Manual". After careful reading, please submit them before the deadline for sending them back indicated in the catalog and on the forms. At the same time, it is recommended that you make a photocopy for backup before filling out and sending back the forms.

2.Safety Reminder

Exhibitors are requested to carefully read the regulations regarding work safety, fire safety, and civilized participation in this "Exhibitor Manual", and please supervise the service providers you entrust to strictly comply with the above - mentioned regulations.

3.Disclaimer Reminder

The organizer of the MRO Guangzhou will try the best to provide high - quality services in all aspects to meet the requirements of exhibitors. However, the organizer will not assume any liability under the following circumstances:

- 1.Delays caused by sending back the forms after the deadline, or failure to provide part or all of the services due to this;
- 2.Surcharges caused by overdue applications, or failure to provide part or all of the services due to this;
- 3.Delays, compensation, losses, etc. caused by not complying with the exhibition regulations and relevant laws and regulations;
- 4.Delays, losses, disputes, etc. caused by not using the service providers recommended by the exhibition;
- 5.The accuracy and timeliness of the published materials submitted by exhibitors and booth constructors themselves.

SCHEDULE

Content	Date	Time
Opening Ceremony	March 18, 2025	9:00-9:30
Conference	March 18, 2025	10:30-17:00
Exhibition BTOB Meeting Workshops Maintenance Skills Competition	March 18-19, 2025	9:00-17:00
	March 20, 2025	9:00-12:00

Exhibitor registration, move-in and move-out time

Content	Date	Time	Remark
Open to online meetings selection	February 26,2025		Suppliers and buyers meeting selection
Closing of BTOB registration platform	March 04,2025		Suppliers registration deadline
	March 11,2025		Buyers registration deadline
Closing of meeting's selection and validation	March 15,2025		Deadline for selection and validation of buyers and suppliers
Exhibitor Check-in	March 17,2025	9:00-17:00	Entrance of Hall 2
	March 18,2025	8:30 start	Entrance of Hall 2
Construction of Special booth	March 16-17,2025	09:00-17:00	Overtime work requires application in advance
Construction of standard booth	March 17,2025	09:00-17:00	
Move-out	March 20,2025	13:00-the morrow 00:00	Exit Pass will be issued from 12:00

01 BASIC INFORMATION

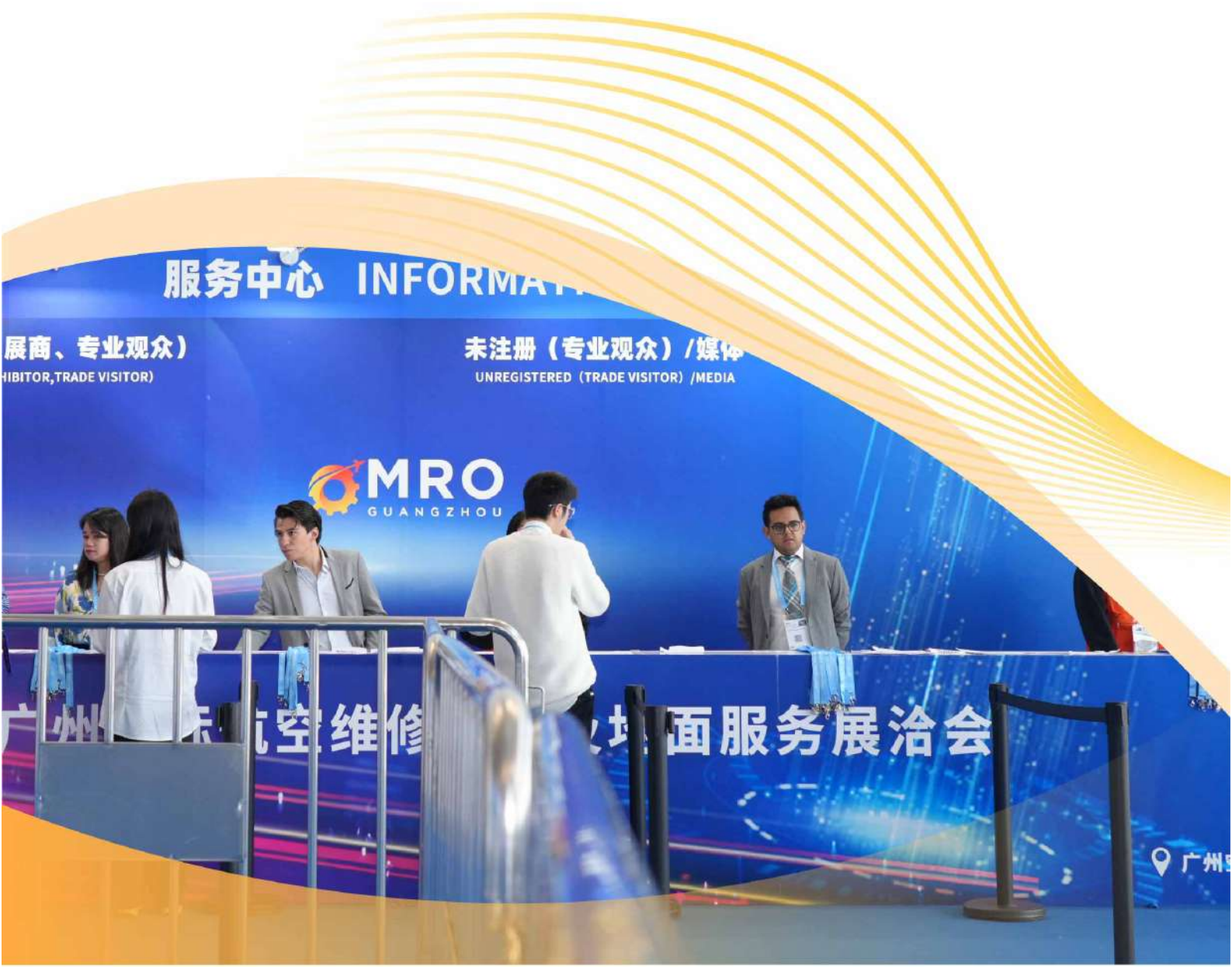

BASIC INFORMATION

Event Name

MRO GUANGZHOU

Date

March 18-20, 2025

Venue

Guangzhou Aerotropolis Expo Center
No. 1108, Yingbin Avenue, Baiyun
District, Guangzhou, China

Scale

2 exhibition halls
Nearly 20,000 sqm
Approx. 8,000 professional
visitors

Types

Aircraft maintenance, Engine maintenance, Propeller maintenance, Component maintenance, Other maintenance services (such as engine replacement, Landing gear replacement, etc.), Non-destructive testing, Borescope inspection technology, Aircraft painting, Aircraft dismantling, Passenger-to-freighter conversion services, Spare parts and components, Ground handling and services, Maintenance technical support, Consulting and solutions, Training and research institutions, Exhibition of research findings from training institutions, universities, and research institutions in the aviation maintenance field, Logistics and transportation services, Aviation logistics solutions, Transportation services, Exhibition of aviation industrial parks.

Highlights

Exhibition, Conference, B2B meetings,
Aviation maintenance skills competition.

Exhibition official platform

Website (Chinese): www.mrosummit.cn

Website (English): www.mrosummitchina.com

WeChat Official Account:



ORGANIZATION

Hosted by

Advanced Business Events SAS
Guangzhou Aiboyi Business Consulting Co.,Ltd

Supported by

Guangzhou Aerotropolis Development District
China Southern Technic
Guangzhou Aircraft Maintenance Engineering
MTU Maintenance Zhuhai
SYNOR-A
Guangzhou Civil Aviation College
Guangdong Airport Management Corporation
HNA Aviation Technic

VENUE

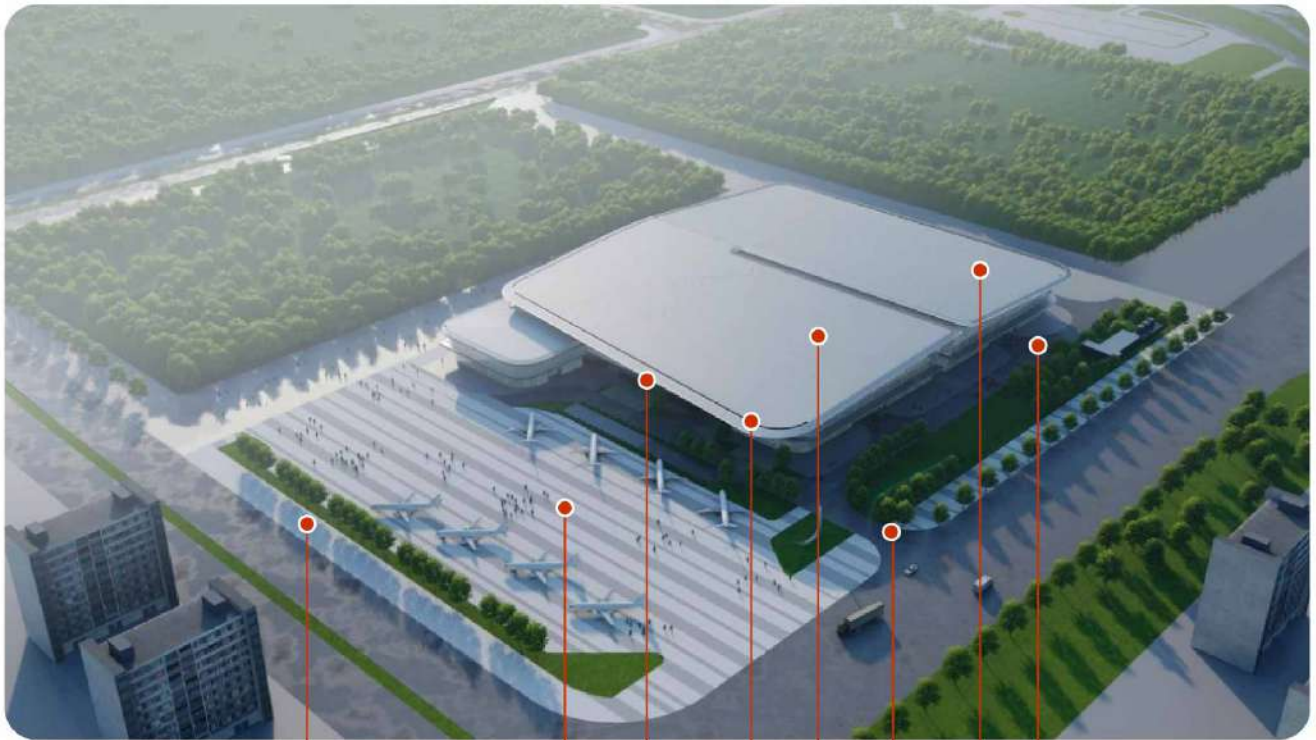

Vehicle Entrance
/Exit for Exhibition Area

Parking Lot

Exit for
Exhibition Area

Hall 1

Pedestrian
Entrance/Exit

Hall 2

Entrance to
Exhibition Hall



Transport

Guangzhou Baiyun International Airport

Bus:

Terminal 1 Bus Stop:

Take Airport Line 2 (bound for Renhe Huacheng Road Park Station) and get off at Guangzhou Aerotropolis Expo Center

Terminal 1 (Gate 25) Bus Stop:

Take Bus 708 (bound for Renhexu Wanjiafu Plaza Terminal Station) and get off at Guangzhou Aerotropolis Expo Center.

Terminal 2 Bus Stop:

Take Airport Line 2 (bound for Renhe Huacheng Road Park Station) and get off at Guangzhou Aerotropolis Expo Center.

Subway:

Take Line 3 (bound for Tiyuxi Road) and get off at Gaozeng Station (Exit B).

For passengers arriving at Areas A and B of Terminal 1, please follow the on-site signage to the atrium on the basement first floor of the terminal to take Line 3 of the subway.

For passengers arriving at Terminal 2, please follow the on-site signage to walk to Exit A of the Transportation Center to take Line 3 of the subway.



Hong Kong Airport

Ferry:

You can purchase ferry tickets from Hong Kong Airport to Guangzhou Pazhou Hong Kong - Macao Passenger Terminal through the "Pazhou Hong Kong - Macao Port" mini-program or comprehensive travel websites such as Ctrip.

After arriving at Pazhou Hong Kong - Macao Passenger Terminal, walk to Exhibition East Station and take the Haizhu Tram Line 1 (Guangzhou Tower direction).

Transfer to Subway Line 3 (Tianhe Coach Terminal direction) at Guangzhou Tower Station.

Then transfer to Subway Line 3 North Extension (Airport North Terminal 2 direction) at Tiyuxi Road Station and get off at Gaozeng Station (Exit B).

Bus:

After claiming your luggage, follow the signs "To Mainland / Macao Transportation" to find the bus counter.

You can purchase tickets through mini-programs such as "Guangdong - Hong Kong Direct Bus", "Yongdong Direct Bus", "China Travel Bus" or at the on-site counter.

High-speed Train:

You can purchase high-speed train tickets from Hong Kong West Kowloon to Guangzhou South Station / Guangzhou East Station through comprehensive travel websites such as Ctrip.

After arriving at Guangzhou South Station, take Subway Line 2 (Jiahe Wanggang direction).

Transfer to Subway Line 3 North Extension (Airport North Terminal 2 direction) at Jiahe Wanggang Station and get off at Gaozeng Station (Exit B).

After arriving at Guangzhou East Station, take Subway Line 3 North Extension (Airport North Terminal 2 direction) and get off at Gaozeng Station (Exit B).

Transport

Guangzhou High-Speed Railway Station / Railway Station

Guangzhou North Station:

Subway: Line 9 (Gaozeng direction)

Get off at Gaozeng Station (Exit B)

Guangzhou East Station:

Subway: Line 3 North Extension (Airport North Terminal 2 direction)

Get off at Gaozeng Station (Exit B)

Guangzhou Railway Station:

Subway: Line 2 (Jiahe Wanggang direction)

Transfer to Line 3 North Extension (Airport North Terminal 2 direction) at Jiahe Wanggang Station

Get off at Gaozeng Station (Exit B)

Guangzhou South Station:

Subway: Line 2 (Jiahe Wanggang direction)

Transfer to Line 3 North Extension (Airport North Terminal 2 direction) at Jiahe Wanggang Station

Get off at Gaozeng Station (Exit B)



Self-driving

Navigate via Gaode / Baidu Maps to Guangzhou Air Port Exhibition Center

Address: No. 1108, Yingbin Avenue, Baiyun District, Guangzhou City, Guangdong

*There is a free parking lot inside the exhibition hall, and there is no need to apply for a parking permit in advance. However, please note that the parking spots are limited.



02

BOOTH DESIGN & CONSTRUCTION

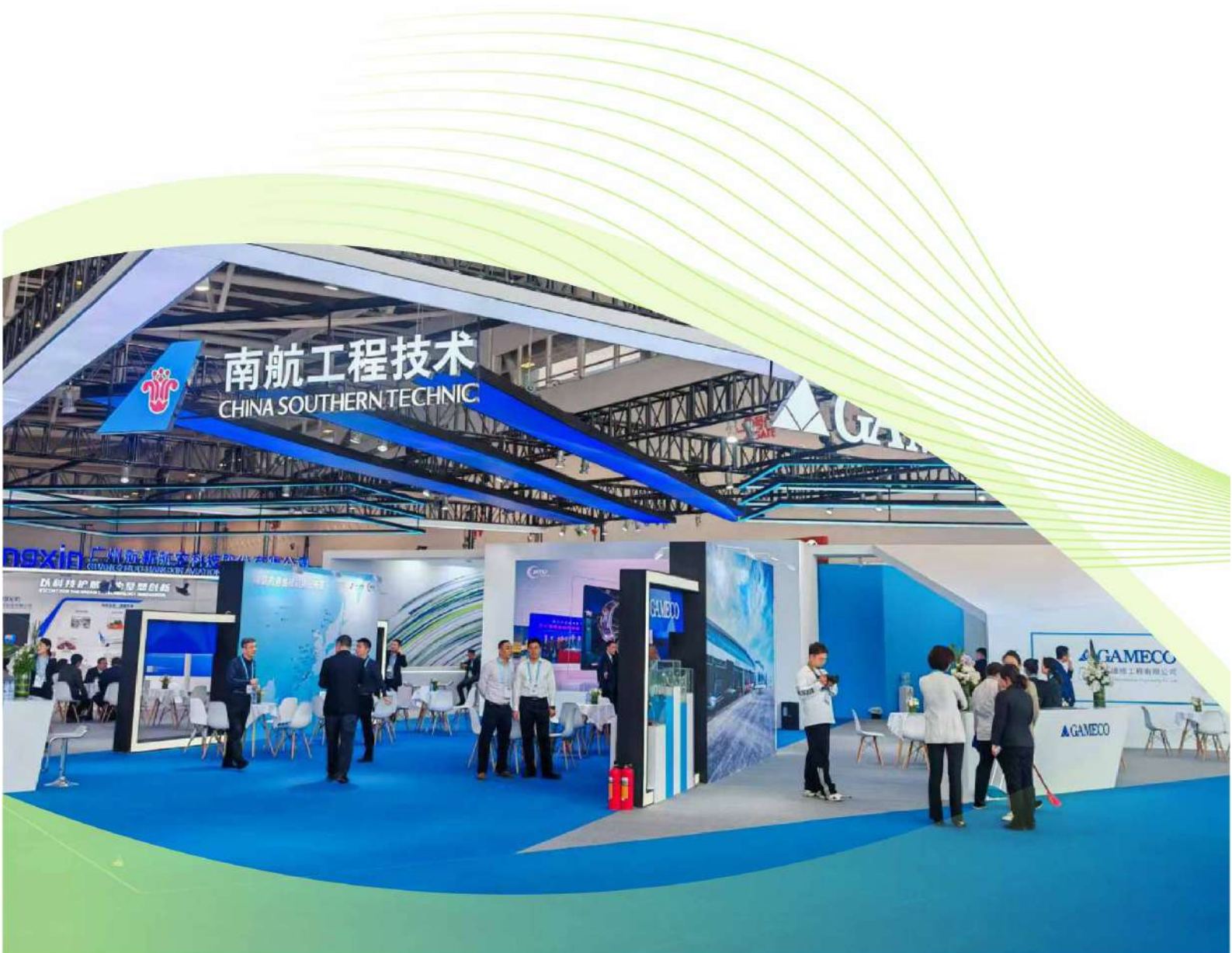

OFFICIAL CONTRACTOR

Company name: Tianjin Northern Performing Arts Group Stage Arts Co., Ltd.

Contact: Yi CAO

Tel: +86 159 2215 0652 **E-mail:** cao.y@advbe.com.cn

RMB Account: 122916820310001

USD Account: 122916820332001

Euro Account: 122916820335001

Depository Bank: China Merchants Bank Co., Ltd. Tianjin Nanbei Street Branch

SWIFT CODE: CMBCCNBS391

Due to the requirements of the exhibition venue, to ensure the smooth and safe progress of the exhibition, smoking is strictly prohibited throughout the venue. In addition to signing the corresponding construction safety responsibility statement, special booth constructors must also sign a special booth fire safety responsibility statement with the official contractor and pay a special booth fire safety guarantee deposit. The deposit will be refunded if there is no breach of contract after the exhibition.

The official contractor for the exhibition is Tianjin Northern Performing Arts Group Stage Art Co., Ltd., responsible for the construction of standard booths; rental services for furniture, electrical appliances, and lighting facilities; management of construction for net land booths; and collection and declaration services for facilities such as water, electricity, gas, telephone network lines, and hoisting points. For specific regulations and charging standards, please refer to the relevant contents of booth design and construction.

FACILITY LEASING SERVICES

Rental of water, electricity and gas facilities

- 1) For booths that require supporting water, electricity and gas facilities for rental, exhibitors must submit their applications by March 1, 2025 to the official contractor . In order to ensure the safety of electricity consumption at the booth and prevent electrical fire accidents, the contractor will be responsible for providing a secondary electrical box with earth leakage protection and for dismantling and installing the box . For details, please refer to the attached table: "Application Form for Rental of Exhibition Supporting Facilities" .
- 2) If the booth requires 24-hour power supply, exhibitors must submit an application to the official contractor before March 1, 2025. Please refer to the attached table for details: "24-hour electricity application form for exhibition booths".
- 3) For booths that require early power delivery and commissioning, exhibitors must submit an application by March 1, 2025 to the official contractor . For details, please refer to the attached "Application Form for Early Delivery of Electricity to Exhibition Stands" .
- 4) The booth electrical box is divided into lighting box and power box. Exhibitors should indicate the type of electrical box when applying to the official contractor. When applying for a power box, the application must be submitted to the official contractor before March 1, 2025.
- 5) Exhibitors are advised to bring their own air compressor and submit a request to the official contractor by March 1, 2025 if they have a compressed air requirement.

Internet and telephone rental

If exhibitors need to rent internet and telephone facilities for their booths, they must submit an application to the official contractor before March 1, 2025. Please refer to the attached table for details: "

Application Form for Lease of Exhibition Supporting Facilities". To further strengthen the network security work of the exhibition, the organizer has formulated a network security management notice. Please refer to the attached "Network Security Management Notice" and "Exhibitor Electronic Display Network Security Responsibility Notice" for details.

Furniture rental

Exhibitors wishing to rent furniture rental must submit an application to the official contractor by March 1, 2025, as detailed on the attached Furniture Rental Application Form. On-site applications may not be able to fulfill the demand.

Rental of Flowers and Plants

Exhibitors wishing to rent plants and flowers must submit an application to the official contractor no later than March 1, 2025, or apply on-site. Please see the attached Flower and Plant Rental Application Form for details. On-site applications may not be able to fulfill demand.

Lifting Point Service

Exhibitors who require lifting point service must submit an application to the official contractor no later than March 1, 2025, along with the preliminary(electronic version), please refer to the attached "Application Form for Lifting Point Rental" for more details.

STANDARD BOOTH

12 square meters: 4mx3mx2.5m

Material: octagonal columns + KT boards

Configuration: 1 storage room, 4 chairs, 1 round table, 1 reception desk, 1 single-sided sign: exhibitor's name + booth number, trash can, power supply, carpet, 2 spotlights.

Option 1: Exhibitors design, produce and install their own posters;

Option 2: Exhibitors design posters and send them to the organizing committee for production and installation; the organizing committee will charge RMB 100 per square meter.

Send all promotional poster files to email: liu.k@advbe.com.cn

Tel. +86 13920550679 Kun LIU



Screen size 1: 2970mmX2480mm(Overall dimensions)

Screen size 2: 960mmX2480mm(Dimension of an individual block)

Screen size 3: 950mmX610mm

Screen size 4: 960mmX2480mm (Dimension of an individual block)



CUSTOMIZED SPECIAL BOOTHS

24 square meters

Note: Exhibitors provide high-definition LOGO, Promotional posters

Configuration: 1 set of sofa (2 single sofas + 1 coffee table), 1 storage room, 1 set of reception desk (table + chairs), 1 round table, 4 chairs, 1 set of water dispenser (with 2 barrels of water), 2 power sockets (5-hole), 1 trash can, carpet, basic lighting, posters(7)

Send all promotional poster files to email:liu.k@advbe.com.cn

Tel. +86 13920550679 Kun LIU

Customized Special Booths : 24m²



Signage 1 to 5: Exhibitors will provide visuals, the official contractor will be responsible for production and installation.

- 1 Board:2.5mx1m
- 2 Reception desk:0.7mx1m
- 3 Board:2.5mx2m
- 4 Exhibitor sign: 1mx2m
- 5 Exhibitor sign: 1mx2m

Tips: The content of the Exhibitor sign is suggested to be the corporate logo.

Optional Signage 6 to 11: additional fees are required if ordered.Exhibitor provides design and the official contractor is responsible for fabrication and installation.

- 6 Board: 2.5mx3m (¥ 750 \$120)
- 7 Board: 2.5mx2m (¥ 500 \$80)
- 8 Board: 2.5mx2m (¥ 500 \$80)
- 9 Board: 2.5mx6m (¥ 1500 \$220)
- 10 Board: 2.5mx1m (¥ 250 \$40)
- 11 TV 42": (¥ 1000 \$160)

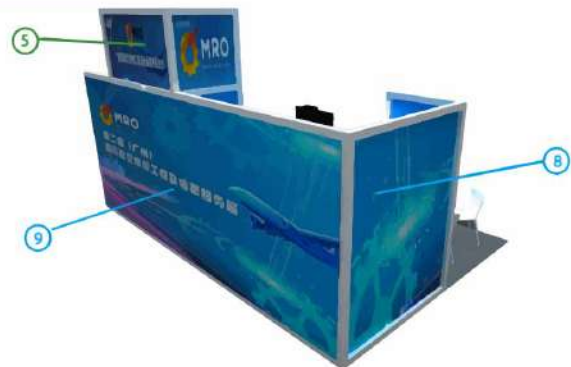
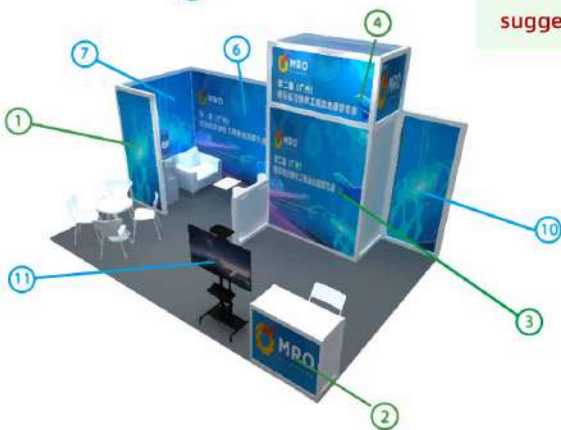

CUSTOMIZED SPECIAL BOOTHS

36 square meters

Note: Exhibitors provide high-definition LOGO, Promotional posters

Configuration: 1 storage room, 1 set of sofa, 1 coffee table, 2 round tables, 8 chairs, 1 reception desk, 1 set of water dispenser (with 2 barrels of water), 2 power supplies (five-hole), 1 trash can, carpet, basic lighting, posters(7)

Send all promotional poster files to email:liu.k@advbe.com.cn

Tel. +86 13920550679 Kun LIU

Customized Special Booths : 36m²



Signage 1 to 5: Exhibitors will provide visuals, the official contractor will be responsible for production and installation.

- 1 Board:2.5mx1m
- 2 Board:2.5mx2m
- 3 Reception desk:0.7mx1m
- 4 Exhibitor sign: 1mx2m
- 5 Exhibitor sign: 1mx2m

Tips: The content of the Exhibitor sign is suggested to be the corporate logo.

Optional Signage 6 to 10: additional fees are required if ordered. Exhibitor provides design and the official contractor is responsible for fabrication and installation.

- 6 Board: 2.5mx3m (¥ 750 \$110)
- 7 Board: 2.5mx3m (¥ 750 \$110)
- 8 Board: 2.5mx6m (¥ 1500 \$220)
- 9 Board: 2.5mx4m (¥ 1000 \$150)
- 10 TV 42": (¥ 1000 \$160)



03 EXHIBITION SERVICES



GENERAL INFORMATION

Badge

Badge (Buyer、Exhibitor、Visitor)

Buyer Registration

<http://www.mrosummit.cn/col.jsp?id=169>

Contact: Mingzhen Dou Phone:+86 133 6607 8037

Email: dou.mz@advbe.com.cn

Visitor registration

<https://expo.369zhan.com/s/r250318.html>

Exhibitor registration

Please fill in the form below and send it to **both** email addresses below by **March 7 2025**.

Company (Full Name)	Website	Name	Department	Position	Phone	Email

Contact:

Dandan XING Phone:+86 181 0210 2732 Email: xing.dd@advbe.com.cn

Yuhan ZHANG Phone:+86 181 4228 2318 Email: zhang.yh@advbe.com.cn

On-site Activities Registration

Exhibitors must declare to the organizer in advance any on-site activities (including but not limited to conferences, events, press conferences, performances, advertising, distribution of gifts and materials, etc.) that will be held in the booth, and can only proceed with the approval of the organizer or relevant units.

For self-organized activities, please contact:

Contact : Mingzhen DOU

Phone: +86 133 6607 8037

Email: dou.mz@advbe.com.cn

GENERAL INFORMATION

Advertising

The MRO Guangzhou has carefully built a stage for exhibitors to showcase their corporate image.

For specific advertising location details, prices, and sales information, please refer to our "Advertising Booking Form."

If you have any inquiries needs, please feel free to contact the sales staff at any time.



EXHIBITION SERVICE PROVIDER

Suggested Suppliers for Raw Space

Company Name	Contact	Phone	Email
Tianjin Northern Performing Arts Group Stage Arts Co., Ltd	Yi CAO	+86 159 2215 0652	cao.y@advbe.com.cn
Guangzhou Jincheng Exhibition Planning Co., Ltd	Weibin ZOU	+86 136 1003 2251	452206906@qq.com
Tianjin Huanli Exhibition Service Co.,Ltd	Manager LI	+86 156 9228 3735	tj_hlzs@163.com

Drawing Review Service Provider

All raw space booths are required to provide a safety report issued by a qualified audit company. Exhibitors may use the drawing review company recommended by the organizing committee. Alternatively, they can choose a professional institution (i.e., the booth design plan is approved by a national first-class registered structural engineer) for drawing review, followed by a recheck conducted by the drawing review company recommended by the organizing committee. The review fee is 25 RMB per square meter; the recheck fee is 18 RMB per square meter.

Officially recommended drawing review companies: Zhongshu Design Group Co., Ltd. Xiamen Branch

Engineer Zhao 18859200189

Engineer Zhang 18910024888

Car Rental

Guangzhou Shunhang Car Rental Service Co., Ltd. Contact: Mr. Dai (Driver)

Phone: 13711669617 Email: 565611255@qq.com

CC: zhang.yh@advbe.com.cn

Insurance

Ping An Property & Casualty Insurance Company of China, Ltd.

Contact : Chenglin YE Phone: +86 13702151350 Email: 411163308@qq.com

EXHIBITION SERVICE PROVIDER

Cleaning

Guangzhou SHENGYUAN Environmental Technology Co. LTD

Dan Hanhu

Phone: 13005479888

Email address: 376264281@qq.com

Express Service

The express service of the exhibition hall is provided by SF Express.

Tea Break

Company: Xi Dian baking Contact: Miss Cheng

Phone: 17722717501

Email: 1063434751@qq.com

CC:zhang.yh@advbe.com.cn

Hotel Recommendation

Southern Airlines Pearl

NO.9,Airport Avenue,Baiyun International
Airport,Huadu District,Guangzhou

Stars: ☆☆☆☆

Phone: +86 18102102732

Email: xing.dd@advbe.com.cn

Distance to the exhibition centre: 8.3km

Shuttle bus: Yes

MRO GUANGZHOU Price (All included)

King Room - Single breakfast CNY 380.00

Twin bed room - Double breakfast CNY 380.00



南航明珠空港大酒店
SOUTHERN AIRLINES PEARL



EXHIBITION SERVICE PROVIDER

Hotel Recommendation

Crowne Plaza Guangzhou Huadu
No.189 Yingbin Avenue, Huadu District,
Guangzhou, 51800, P.R.China

Stars: ☆☆☆☆☆

Phone: +86 15915796424

Email: Sissi.Zou@crowneplazahuada.com

Distance to the exhibition centre: 4.8km

Shuttle bus: Yes

MRO GUANGZHOU Price (All included)

King Room - Single breakfast CNY 680.00

Twin bed room - Double breakfast CNY 780.00



Baiyun Airport Rezen Select Hotel
Building 14-A, No. 9 Airport Avenue,
Baiyun International Airport, Guangzhou,
Guangdong Province

Stars: ☆☆☆☆☆

Phone: +86 18029332889

Email: 464573253@qq.com

Distance to the exhibition centre: 9.3km

Shuttle bus: Yes

MRO GUANGZHOU Price (All included)

King Room - Single breakfast CNY 298.00

Twin bed room - Double breakfast CNY 298.00



OUBON AIRPORT HOLIDAY HOTEL
No. 3 Zhenhua Road, Donghua Village,
Renhe Town, Baiyun District, Guangzhou City

Stars: ☆☆☆

Phone: +86 138 0241 0394

Email: 464573253@qq.com

Distance to the exhibition centre: 11km

Shuttle bus: Yes

MRO GUANGZHOU Price (All included)

King Room - Single breakfast CNY 288.00

Twin bed room - Double breakfast CNY 288.00



EXHIBITS TRANSPORTATION

Transport Service

The vehicles, time, and route arrangements for the transportation of exhibits in the exhibition hall are provided by the official transportation service provider.

Exhibitors are advised to contact the official transportation service provider in advance for related services. The organizer shall not be held responsible for any delay, service error or dispute caused by the failure to use the official service provider for the exhibition. For details, please refer to this manual "Exhibit Transportation" .

According to China's customs control requirements, if exhibits are unable to enter the country or be displayed on time because they involve related categories in the prohibited list or restricted list, the resulting losses will be undertaken by the exhibitor and the organizer shall not assume any liability or loss.

The organizer will announce relevant policy information on the official website of the exhibition as soon as possible. Please pay attention to the "Supporting Services - Exhibit Transportation" column on the official website of the Guangzhou MRO Exhibition (www.mrosummit.cn).

EXHIBITS TRANSPORTATION

Transportation Service Provider (Inside The Exhibition Center)

Guangzhou Dingsheng Loading and Unloading Service Co., LTD.

Company Address: Guangzhou Haizhu District Xingang Road No. 533 201

Warehouse Address: Huangpu Chung Bridge, Haizhu District, Guangzhou (777)

Zip Code: 510308

Tel: 020-22156137

Fax: 020-89239964

Exhibition site Contact: Mr. Huang /15914518599

Transportation Contact: Mr. Huang Jianbiao /13710793800 (exhibitors who need transportation can contact)

E-mail: dss98@163.com

Delivery date: March 16, 17 Contact person: Mr. Huang /15914518599

Delivery address: Guangzhou Aerotropolis Expo Center (No.1108, Yingbin Avenue, Baiyun District, Guangzhou)

Charging Standard

Service Item	Unit Price (RMB)	Remarks
Exhibits unloading, entering and booth	120 Yuan/cubic meter/ton	minimum charge of 1 cubic meter or 1 ton
Exhibits out of the museum and loading	120 Yuan/cubic meter/ton	minimum charge of 1 cubic meter or 1 ton
Empty box storage	40 yuan/cubic meter/exhibition period	
Unpacking and packing	unpacking 20 yuan/cubic meter	

04

ATTACHED

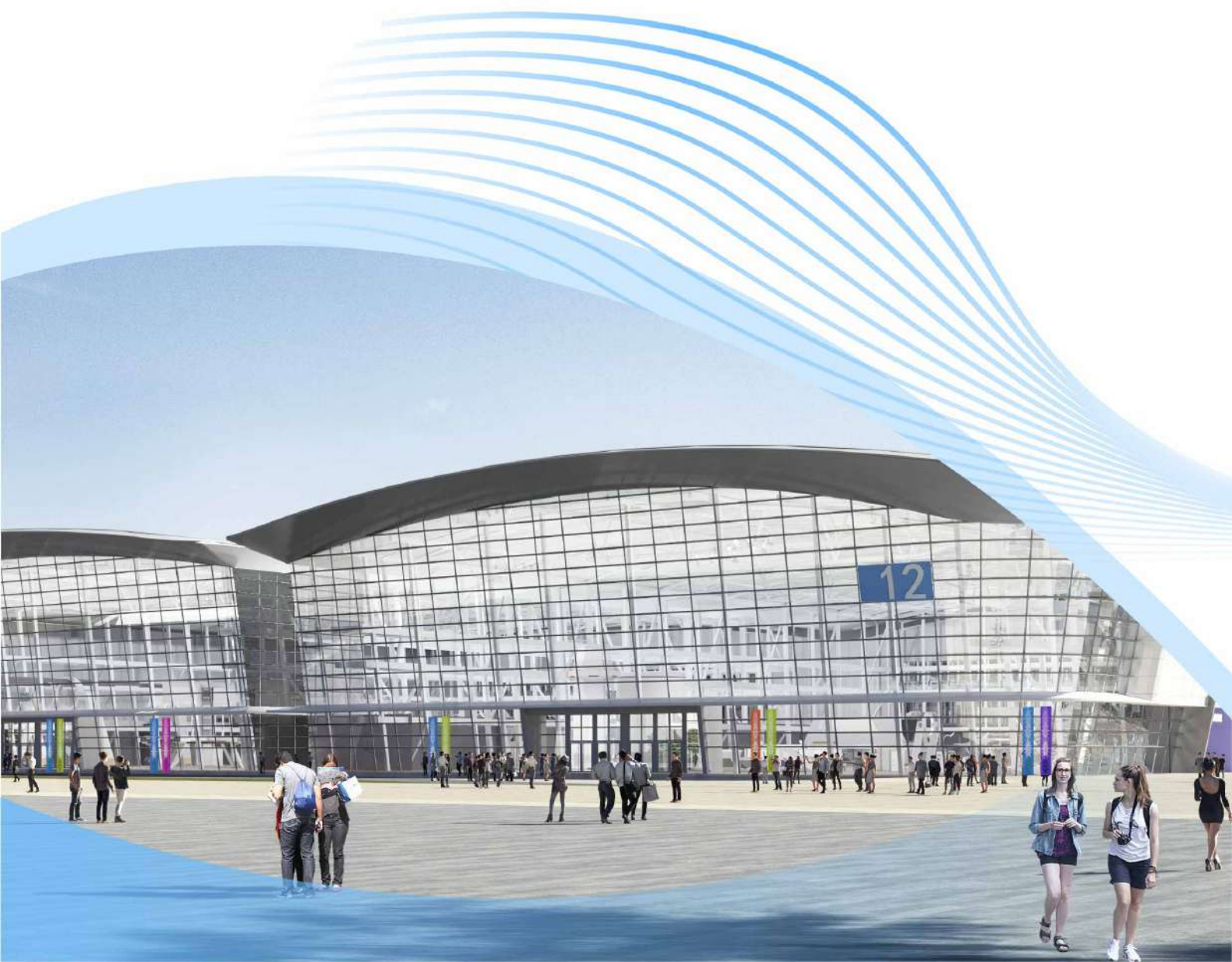

ATTACHED PLANTS RENTAL

Lectern Flowers



①Price:¥268 Size:35*40cm



②Price:¥388 Size:35*50cm



③Price:¥338 Size:35*40cm



④Price:¥410 Size:35*50cm



⑤Price:¥408 Size:35*40cm



⑥Customized model price ¥188 or more (by price and color match)

Large Green Potted Plants



Size: 170cm
Rubber basin:
¥ 178

Size: 170cm
Ceramic
basin: ¥ 268

Fortune Tree (Single)



Size: 180cm
Rubber basin:
¥ 218

Size: 180cm
Ceramic basin:
¥ 328

Dypsis lutescens



Size: 110cm
Rubber basin:
¥ 208

Size: 110cm
Ceramic basin:
¥ 378

Zamioculcas zamiifolia



Size: 170cm
Rubber basin:
¥ 348

Size: 170cm
Ceramic
basin: ¥ 478

Fortune tree (three)



Size: 140cm
Rubber basin:
¥ 208

Size: 140cm
Ceramic basin:
¥ 300

Monstera deliciosa



Size: 180cm
Rubber basin:
¥ 228

Size: 180cm
Ceramic basin:
¥ 328

Bird of Paradise

ATTACHED PLANTS RENTAL

Mini Lectern Flowers



①Price:¥95 Size:15*15cm



②Price:¥95 Size:15*15cm



③Price:¥85 Size:15*15cm



④Price:¥68 Size:15*15cm



⑤Price:¥78 Size:15*15cm



⑥Customized model price
¥28 or more (by price and
color match)

Small Green Potted Plants



①Price:¥16 Size:20*25cm



②Price:¥23 Size:45cm



③Price:¥16 Size:20cm



④Price:¥45 Size:36*40cm



⑤Price:¥30 Size:45cm



⑥Price:¥38 Size:20cm

Note:
For further details, please contact Yi CAO E-mail: cao.y@advbe.com.cn.

ATTACHED PLANTS RENTAL

Plants Rental Service Price

No.	Content	Unit	Quantity	Price	Remark
(三)	Flower rental				
	Podium flower				
1	①Podium flower size :35*40 cm	Bouquet		268.00	
2	②Podium flower size: 35*50 cm	Bouquet		388.00	
3	③Podium flower size: 35*40 cm	Bouquet		338.00	
4	④Podium flower size: 35*40 cm	Bouquet		410.00	
5	⑤Podium flower size: 35*40 cm	Bouquet		408.00	
6	Customized model price	Bouquet		188.00or more	
	Large green potted plants				
1	Fortune Tree (Single)Size: 170cm Rubber basin	Pot		178.00	
2	Fortune Tree (Single)Size: 170cm Ceramic basin:	Pot		268.00	
3	Dypsis lutescens Size: 180cm Rubber basin	Pot		218.00	
4	Dypsis lutescens Size: 180cm Ceramic basin	Pot		328.00	
5	Zamioculcas zamiifolia Size: 110cm Rubber basin	Pot		208.00	
6	Zamioculcas zamiifolia Size: 110cm Ceramic basin	Pot		378.00	
7	Fortune tree (three) Size: 170cm Rubber basin	Pot		348.00	
8	Fortune tree (three) Size: 170cm Ceramic basin	Pot		478.00	
9	Monstera deliciosa Size: 140cm Rubber basin	Pot		208.00	
10	Monstera deliciosa Size: 140cm Ceramic basin	Pot		300.00	
11	Bird of Paradise Size: 180cm Rubber basin	Pot		228.00	
12	Bird of Paradise Size: 180cm Ceramic basin	Pot		328.00	
	MINI lectern flowers				
1	①MINI lectern flowers Size: 15*15cm	PCS		95.00	
2	②MINI lectern flowers Size: 15*15cm	PCS		95.00	
3	③MINI lectern flowers Size: 15*15cm	PCS		85.00	
4	④MINI lectern flowers Size: 15*15cm	PCS		68.00	
5	⑤MINI lectern flowers Size: 15*15cm	PCS		78.00	
6	⑥Customized model	PCS		28.00or more	
	Small green potted plants				
1	①Small green potted plants Size: 20*25cm	Pot		16.00	
2	②Small green potted plants Size: 45cm	Pot		23.00	
3	③Small green potted plants Size: 20cm	Pot		16.00	
4	④Small green potted plants Size: 36*40cm	Pot		45.00	
5	⑤Small green potted plants Size: 45cm	Pot		30.00	
6	⑥Small green potted plants Size: 20cm	Pot		38.00	

Explain :

- (1) The above price is a comprehensive unit price, including tax;
- (2) The above prices are discounted for the booking period, there will be a 30% increase for late rentals and a 50% increase for on-site rentals.

ATTACHED FURNITURE RENTAL

Furniture rental: Only applicable for standard booths

Deadline: March 8, 2025

Exhibitors with rental needs should accurately fill out the unit rental exhibition equipment item list and send it to the designated email address of the official contractor.

Contact :Kun LIU

Phone: +86 13920550679

Email: liu.k@advbe.com.cn



The reception desk
1000L*500W*750H
¥120.00/piece



locked cabinet
1000L*500W*750H
¥140.00/piece



Glass-fronted cabinet
1000L*500W*1000H
¥380.00/piece



Tall glass-fronted cabinet
1000L*500W*2500H
¥600.00/piece



wooden shelf
1000L*300W
¥50.00/piece



two-level cabinet
1000L*500W*1000/750H
¥220.00/piece



Square table
700*700*750H
¥120.00/piece



Glass round table
D700*750H
¥160.00/piece



high display case
1000L*500W*2000H
¥450.00/piece



aluminum column
display rack
(with wooden shelves)
1000L*500W*2500H
¥280.00/meter



Folding
chair
¥30.00/piece



aluminum alloy
chair
¥60.00/piece



Bar
chair
¥120.00/piece

ATTACHED FURNITURE RENTAL



Wall panel
1000L*2500H
¥90.00 / piece



A wooden door with a lock.
1000L*2000H
¥220.00 /piece



Carpet 250G
¥25.00 /sqm



KT board
¥100.00 /sqm



power sockets
¥120.00 / piece



Perforated terminal board
¥780.00 /piece



Water dispenser
(with 2 barrels of water)
¥350.00 /piece



42 inch plasma TV
Including bracket
¥1000.00 /piece



Metal Halide Lamp
150W
¥220.00 /piece



Long arm spotlight
100W
¥120.00 /piece



fluorescent lamp
40W
¥120.00 /piece

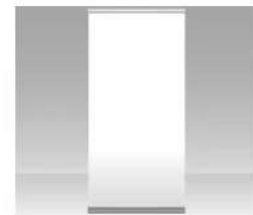

Portable Display
800L*2000H
¥200.00 /piece

Remarks:

If the application is not made in accordance with the regulations in advance, the overdue rental fee will increase by 30%-50%. On-site applications cannot ensure provision.

ATTACHED FURNITURE RENTAL

Furniture And Electrical Appliances Rental Service Prices

No.	Content	Unit	Quantity	Price	Remark
(一)	Display Fixtures and Stands				
1	The reception desk 1000L*500W*750H	Piece		120.00	
2	locked cabinet 1000L*500W*750H	Piece		140.00	
3	Glass-fronted cabinet 1000L*500W*1000H	Piece		380.00	
4	Tall glass-fronted cabinet 1000L*500W*2500H	Piece		600.00	
5	high display case 1000L*500W*2000H	Piece		450.00	
6	aluminum column display rack (with wooden shelves) 1000L*500W*2500H	Meter		280.00	
7	wooden shelf 1000L*300W	Piece		50.00	
8	two-level cabinet 1000L*500W*1000/750H	Piece		220.00	
9	Square table 700*700*750H	Piece		120.00	
10	Glass round table D700*750H	Piece		160.00	
11	Folding chair	Piece		30.00	
12	aluminum alloy chair	Piece		60.00	
13	Bar chair	Piece		120.00	
14	Wall panel 1000L*2500H	Piece		90.00	
15	A wooden door with a lock 1000L*2000H	Piece		220.00	
16	Carpet 250G	sqm		25.00	
17	KT board	sqm		100.00	
18	Portable Display 800L*2000H	Piece		200.00	
(二)	Electrical Appliances and Equipment				
1	power sockets	Piece		120.00	
2	Perforated terminal board	Piece		780.00	
3	Long arm spotlight (100W)	Piece		120.00	
4	Fluorescent lamp (40W)	Piece		120.00	
5	Metal Halide Lamp (150W)	Piece		220.00	
6	42 inch plasma TV Including bracket	Piece		1000.00	
7	Water dispenser (with 2 barrels of water)	set		350.00	

Explain:

- (1) The above price is a comprehensive unit price, including tax;
- (2) The above prices are discounted for the booking period, there will be a 30% increase for late rentals and a 50% increase for on-site rentals.

***must submit an application to the official contractor no later than March 1, 2025, or apply on-site.**

Contact: Kun LIU email:liu.k@advbe.com.cn Tel. +86 13920550679

FASCIA BOARD

Company Name In Chinese	
Company Name In English	

*must submit an application to the official contractor no later than March 1, 2025, or apply on-site.

Contact: HongFei Zhu email:liu.k@advbe.com.cn Tel. +86 13920550679